

STORMWATER - LEGEND

- PROPOSED STORM SEWER
- EXISTING STORM SEWER
- INSPECTION CHAMBER
- LAND DRAIN
- ROAD GULLY
- ATTENUATION TANK
- BIO SWALE WITH OPEN GRATED MANHOLE
- PERMEABLE PAVING
- PRE CAST CONCRETE HEAD WALL
- PROPOSED TREE PIT/BIORETENTION RAIN GARDEN
- OIL SEPARATOR
- INLET KERB

WASTEWATER - LEGEND

- PROPOSED FOUL SEWER
- EXISTING FOUL
- INSPECTION CHAMBER

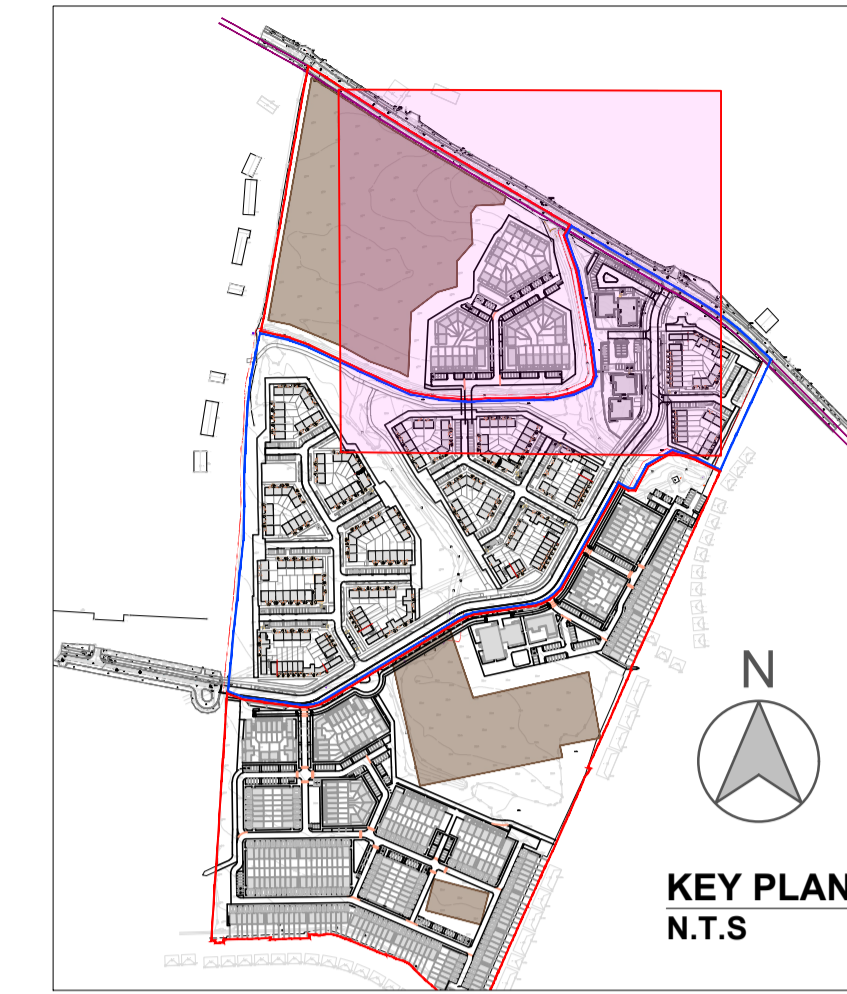

NOTES

1. NO PART OF THIS DRAWING MAY BE REPRODUCED OR TRANSMITTED IN ANY FORM OR STORED IN ANY RETRIEVAL SYSTEM OF ANY NATURE WITHOUT THE WRITTEN PERMISSION OF AKM DESIGN AS COPYRIGHT HOLDER, EXCEPT AS AGREED FOR USE ON THE PROJECT FOR WHICH THE DRAWING IS ORIGINALLY ISSUED.
2. ALL DIMENSIONS ARE IN m UNLESS OTHERWISE NOTED.
3. THE CONTRACTOR SHALL CHECK ALL DIMENSIONS PRIOR TO COMMENCEMENT OF CONSTRUCTION. DISCREPANCIES SHALL BE REPORTED TO THIS OFFICE IN WRITING.

WASTEWATER

1. WASTEWATER SERVICES ARE TO BE IN ACCORDANCE WITH IRISH WATER CODE OF PRACTICE DOC IW-CDS-5030-03.
2. ALL INFRASTRUCTURE WILL BE PROVIDED IN LINE WITH THE IRISH WATER STANDARD DETAILS.
3. uPVC S88 PIPES TO BE USED FOR FOUL WASTEWATER SEWER LAYOUT IN ACCORDANCE TO SECTION 3.13.
4. MANHOLES LOCATED IN GRASS AREAS ARE TO BE SURROUNDED BY A CONCRETE PLINTH, 200MM ALL ROUND AND 100MM DEEP FORMED OF C20/25 CONCRETE, 20MM AGGREGATE SIZE BEDDED IN CASE 804 MATERIAL.
5. MANHOLES DEEPER THAN 3m AND LESS THAN 6m TO BE CONSTRUCTED AS PER IW-CDS-5030-03 SECTION 3.12.
6. SEWER SPACINGS TO BE AS PER IRISH WATER STANDARD DETAIL STD-WW-05.
 - ALL SEWER PIPES TO BE A MINIMUM OF 300mm AWAY FROM OUTSIDE OF MANHOLES.
 - ALL SEWER PIPES TO BE A MINIMUM OF 1000mm AWAY FROM ROAD KERBS.
 - ALL MANHOLES TO BE A MINIMUM OF 500mm AWAY FROM ROAD KERBS.
7. ALL PIPE CROSSINGS WITH LESS THAN 300mm VERTICAL CLEARANCE TO BE ENCASED IN CONCRETE.
8. THE BRIDGE CONNECTION BETWEEN F155 AND F156 SHALL BE CONSTRUCTED USING DUCTILE IRON PIPEWORK WITH STRUCTURAL SUPPORTS AND PIERS DESIGNED IN ACCORDANCE WITH CODE OF PRACTICE AND RELEVANT STRUCTURAL EUROCODES.
9. ALL MANHOLES LOCATED BELOW THE MAXIMUM GROUNDWATER LEVEL ARE TO BE CONCRETE ENCASED AS PER IUCSE EIREANN STANDARD DETAIL STD-WW-10A.

STORMWATER

1. STORMWATER SERVICES ARE TO BE IN ACCORDANCE WITH "RECOMMENDATIONS FOR SITE DEVELOPMENT WORKS", "GREATER DUBLIN REGIONAL CODE OF PRACTICE FOR DRAINAGE WORKS" AND LOCAL AUTHORITY REQUIREMENTS.
2. uPVC S88 PIPES TO BE USED FOR STORM WATER SEWER LAYOUT.

AREA WITH SIGNIFICANT ARCHAEOLOGICAL REMAINS

PHASE 1 - CURRENTLY UNDER CONSTRUCTION.

PROPOSED STORM AND FOUL DRAINAGE - SHEET 3 OF 3

SCALE 1:500

COPYRIGHT RESERVED. ALL DRAWINGS TO BE READ IN CONJUNCTION WITH ARCHITECTURE, STRUCTURAL ENGINEERS & MECHANICAL ENGINEERS DETAILS.

DO NOT SCALE DRAWING. USE FIGURED DIMENSIONS ONLY. ALL DISCREPANCIES TO BE REPORTED TO AKM DESIGN GROUP IMMEDIATELY. ALL DIMENSIONS TO BE CHECKED ON SITE BY MAIN CONTRACTOR PRIOR TO CONSTRUCTION. MAIN CONTRACTOR IS RESPONSIBLE FOR SET-OUT.

DESCRIPTION	REV	DATE
FIRST ISSUE	00	05/26



Innovating tomorrow through design

14 Riverwalk, Citywest, Dublin 24, D24 XN32
T: +353 1 479 6234 E: info@akmdesign.ie akmdesign.ie

STAGE: **S2 - FOR INFORMATION**

DRAWN BY: DO	APPROVED BY: CK	AKM JOB NUMBER: 25051
DATE: 05/26	SCALE: 1:500 @ A1	
REVISION NUMBER: 00	SEQUENCE NUMBER: 300004	

DRAWING NUMBER: 25051-AKM-XXXX-XX-DR-C01-300004

PROJECT TITLE: 25051 - FINGAL MOORETOWN PHASE 2

DRAWING TITLE: PROPOSED STORM AND FOUL DRAINAGE - SHEET 3 OF 3

CLIENT: FINGAL COUNTY COUNCIL